



HOT ISSUES IN HEALTH

DECEMBER 1, 2023 | **HILTON DENVER INVERNESS**



COLORADO HEALTH INSTITUTE
Informing Strategy. Advancing Health.

2023 HOT ISSUES IN HEALTH

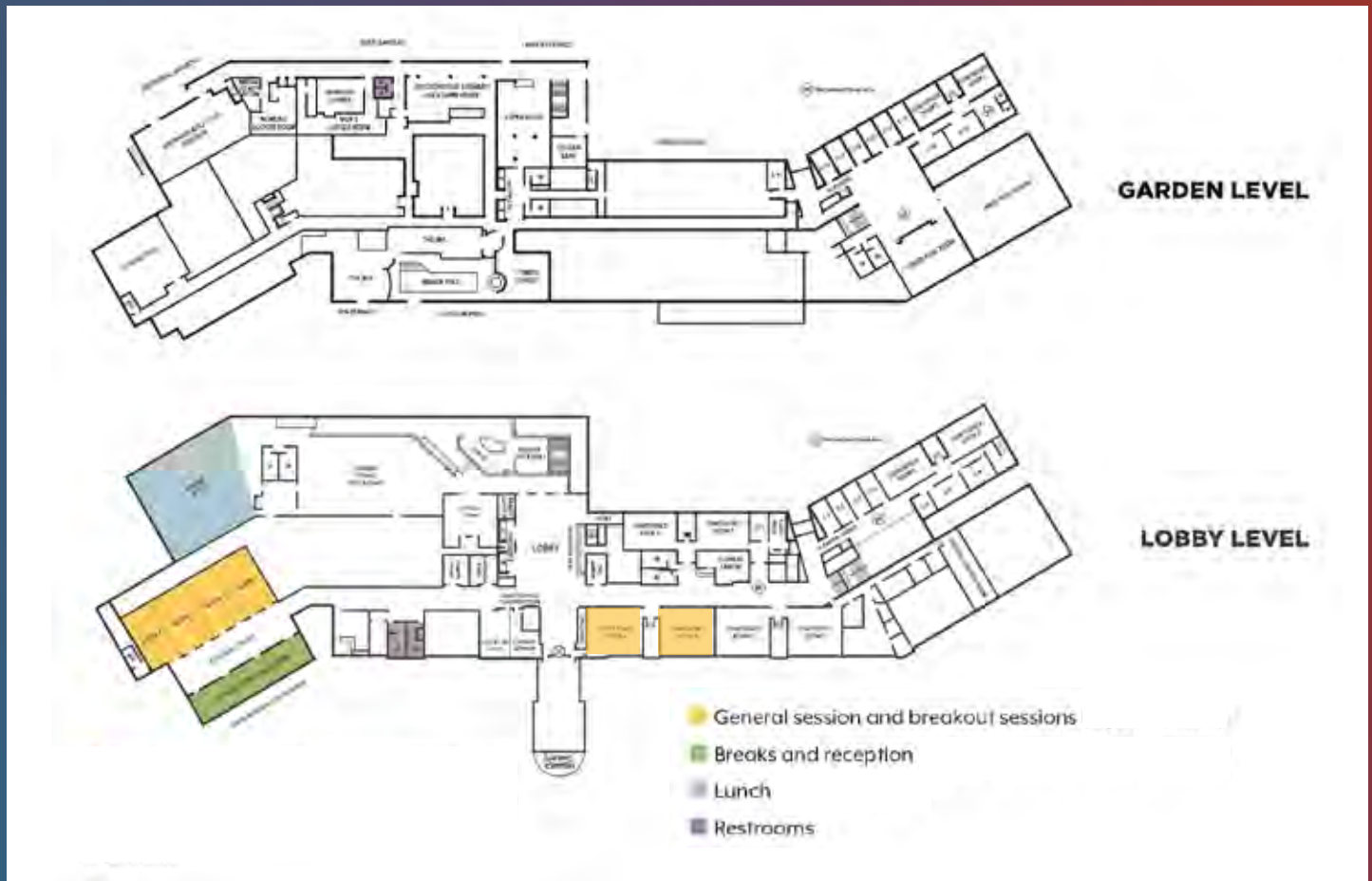

HOTEL MAP

Today's conference takes place in the Alpine Rooms on the Lobby Level. Two breakout sessions will be in Conference Rooms A and B.

Breaks throughout the day and the reception this afternoon will be hosted in the Upper Mountain View Gardens space, across from the Alpine Rooms.

Lunch will be served in the Garden Terrace Restaurant's Sunrise Room.

Restrooms on the Lobby Level are located down the hall and to the right of the Alpine Rooms. Single-occupancy restrooms are available on the Garden Level near the Breckenridge Brewery Ale House. A CHI team member at the registration table can provide directions.

A lactation room, sponsored by Caring for Colorado, is available for attendees. Please contact a CHI team member at the registration table to access the room.



WIFI INSTRUCTIONS

Wifi is generously sponsored by Connect for Health Colorado. To access, locate and connect to the network named: **Get Connected (and Covered)**. Enter the code: **connectforhealthco** when prompted.

Welcome to Hot Issues in Health. Whether this is your first or your 14th time attending, you are welcome here. Thank you for joining us.

Today's gathering is my 10th Hot Issues in Health, but it is my first as the Colorado Health Institute's President and CEO. I am honored and humbled to lead this organization into the future, and I look forward to partnering with all of you as we work together to advance equity and well-being in our communities.

For me, Hot Issues has always been a highlight of the year because it provides an opportunity to connect with changemakers who are united by a commitment to Coloradans' health. Together we will think creatively about the future, hear new perspectives, and plan for how we will improve health in the year ahead. There's value in coming together — gathering around (in person and virtual) tables to have critical conversations and collaborate on ways to move forward.

And there are so many important issues that deserve our attention.

- **Artificial intelligence** is redefining the way we work, bringing with it risks and opportunities that seemed unimaginable just a year ago.
- Communities are being rapidly forced to adapt to a **changing climate**.
- **Social media** plays an outsized, sometimes harmful, role in our daily lives — influencing our health and well-being and that of Colorado's young people.
- **The 2024 legislative session** will once again center health and social factors, while taking a hard look at the impacts of recent policy changes.

Today's preview of findings from the 2023 Colorado Health Access Survey will give us a critical window into how Coloradans are faring on access, coverage, health, and social factors. CHAS data provide us with the long view of these factors, telling us what we can celebrate and where we need to work harder or take a different approach.

CHI was founded more than 20 years ago to provide data, evidence, and insights to inform health and health policy decision-making in Colorado. Then and now, we bring people together to listen to all sides of the story, to reconsider what they thought they knew, and to make progress on difficult topics. The work of improving health for all Coloradans is hard — but worth it.

I invite everyone today to think critically. Ask tough questions. Challenge yourself. Have lunch with someone who may be able to offer a different perspective. And have some fun along the way. I'm eager to engage and hear what you are thinking.

I'll see you at the dessert buffet.



A handwritten signature in black ink that reads "Sara Schmitt".

Sara Schmitt, President and CEO
Colorado Health Institute



LIVESTREAMING AND RECORDING

We are livestreaming the conference for those who are unable to join us in person. If your colleagues could not attend today's conference, they can watch the video stream on CHI's website, www.coloradohealthinstitute.org. A recording of most of the conference will be posted on coloradohealthinstitute.org within a few days of the conference.

Note: Only attendees who registered ahead of the event and are accessing the video stream via Zoom will have access to the keynote remarks. Keynote remarks will not be available online after the conference.



BIKE DRAWING

We love our annual tradition of sending one of our attendees home with a new bicycle, but this year we're giving you more options. The winner of this year's drawing will receive a gift certificate to an outdoor retailer, so if biking isn't your thing, you can get the gear for your sport of choice. Hot Issues attendees will receive two drawing tickets at registration.

Presenters also have extra tickets to give away in their sessions, so participate fully and you might be rewarded. The drawing will take place at the conclusion of the conference, right before the reception. You must be present to win.



ATTENDEE WELL-BEING

We prioritize the health and well-being of all our attendees. If at any point during the event, you or someone you have been in recent contact with begins feeling unwell, we ask that you exit the conference space. A member of our team can provide information about areas where you can safely distance yourself or about obtaining online access, so you don't miss the remainder of the conference.

SOCIAL MEDIA

Join the conversation and keep up with all the Hot Issues action on social media. Follow CHI on LinkedIn, Facebook, Instagram, or X (formerly Twitter) for event updates.

We're [@CoHealthInst](https://www.instagram.com/CoHealthInst) on both Instagram and X. Use the hashtag [#HIHC23](https://twitter.com/CHI_HHC23) to add to the conversation.

Hot Issues in Health is made possible by funding and support from generous sponsor organizations.

The Colorado Health Institute acknowledges and thanks our sponsors, who exhibit a clear commitment to fostering productive policy conversations, moving the needle on health care issues, and advancing health equity in Colorado through their financial support of this conference.

Health Equity Champion Sponsor



Reception Sponsors



Lunch Sponsor



Snack and Networking Station Sponsor



Scholarship Sponsors

Colorado Community Health Alliance • Craig Hospital • Intermountain Health

Wifi Sponsor

Connect for Health Colorado

Lactation Room Sponsor

Caring for Colorado

Prize Sponsor

Green Spaces



ROCKY MOUNTAIN
HEALTH PLANS®

A UnitedHealthcare Company

WE'RE ALL IN FOR ALL OF COLORADO

In collaboration with our partners, we can create equitable, community-centric solutions that drive improved quality and health outcomes.



Rocky Mountain Health Plans is committed
to building healthier communities across Colorado.

See our impact at rockyimpact.com

BUILDING ON 30 YEARS OF IMPACT.

Join us in advancing innovation and collaboration in public health.

www.trailhead.institute/learn-more



We all deserve a safe place to seek medical care.

Health care workers deserve a safe place to provide it.

We all have a role to play in reducing violence against health care workers. Learn more about CHA's

#CULTUREOFCARE campaign at cha.com/cultureofcare.



IMPROVING THE STATE OF YOUTH MENTAL HEALTH

Together, we can create change.

PARTNER WITH PCMH

Email to schedule a Zoom or coffee with Executive Director Michele Lueck or the PCMH team.

info@pcmh.org

Colorado Access is honored to sponsor the snack and networking station for this year's Hot Issues in Health conference.



We hope today's breaks in the agenda help foster new connections and spark conversations to help improve health for all Coloradans.



HOT ISSUES IN HEALTH CONFERENCE AGENDA

8 – 9 a.m. Breakfast

9 – 9:15 a.m. Welcome and Opening Remarks

- **Sara Schmitt**, President and CEO, CHI
- **Kay Ramachandran**, Board of Trustees, CHI
- **Patrick Gordon**, President and CEO, Rocky Mountain Health Plans, a UnitedHealthcare Company

9:15 – 9:45 a.m. A Sneak Peek at the 2023 Colorado Health Access Survey

We start the day with the debut of the 2023 Colorado Health Access Survey, the state's premier source of information on health coverage, access to health care, and the factors that influence health in our state. The Hot Issues in Health audience will be the first to see top-level findings from the survey. The data will provide a critical window into Coloradans' health and will influence how individuals and organizations throughout our state prioritize their health policy work in the coming years. CHI will release full survey results in early 2024.

- **Sara Schmitt**, President and CEO, CHI
- **Jeff Bontrager**, Director of Research and Evaluation, CHI
- **Lindsey Whittington**, Policy Analyst, CHI

9:45 – 10:30 a.m. ChatGPT and Your Brain: Changing How We Think About Thinking

Legal scholar and ethicist Nita Farahany asserts that "Using ChatGPT isn't cheating." She draws a parallel to the transformative shifts in thinking that occurred with the introduction of calculators. As a leading expert in neurotechnology and the author of *The Battle for Your Brain*, Nita suggests that we need to adapt our perspective on thinking and begin mastering the art of asking the right questions. She demonstrates how we can teach the fundamentals of writing, research, and the core principles of art to the next generation, enabling them to use this technology effectively. Through this, we can create critical thinkers who are aware of what they create, and develop a future where humans and technology collaborate and enhance one another.

- **Nita Farahany**, Legal Scholar and Ethicist, Director of the Duke Initiative for Science and Society

10:30 – 10:45 a.m. Break Sponsored by Colorado Access

10:45 – 11:45 a.m. Can Artificial Intelligence Set Us Free? How Rapid Technological Advancement May Finally Deliver the Support We Were Promised

The information age has fallen short of the hype. Data overload continues to grow exponentially, leaving health professionals feeling overwhelmed instead of empowered. Keynote speaker Nita Farahany joins public health innovator and global entrepreneur Kaakpema "KP" Yelapaala to discuss the possibilities (and the pitfalls) for AI to finally deliver actionable insights for clinicians and all Coloradans.

- **Nita Farahany**, Legal Scholar and Ethicist, Director of the Duke Initiative for Science and Society
- **Kaakpema "KP" Yelapaala**, Senior Fellow, Yale School of Public Health
- **Ashlie Brown**, Director, CHI (moderator)

11:45 a.m. – 12 p.m. Morning Recap

12 – 1 p.m. Lunch Sponsored by The Colorado Health Foundation

1-2:15 p.m. Breakout Sessions (select one)

CONFERENCE ROOM A

Transforming Silos into People-First Systems

Why does it feel so challenging to get the care and services we need? What if our public health, health care, and social service systems prioritized people's needs and experiences for building integrated systems around them? The process of journey mapping helps us move forward and solve complex problems better and faster. Join us in this engaging session for an immersive mapping experience. We'll break out of our siloes and adopt a broader perspective with fresh thinking, a new mindset, and an innovative tool to think about how to evolve and better integrate our systems of care.

- **Nina Bianchi**, Director, CHI
- **Kirsti Klaverkamp**, Senior Program Manager, CHI
- **Stephanie Pugliese**, Director, Colorado Office of eHealth Innovation (OeHI)

ALPINE ROOM

Screens: A Youth-Led Guide to Mental Health in the Age of Social Media

From bullying to hate speech to sleep disruption, research has shown that social media affects the development of children and adolescents. Policymakers and parents certainly have a role to play. But ultimately, the actions of young people themselves will have the greatest impact. Join CHI for a brief presentation on what the research says about social media and young minds, followed by a panel discussion featuring the voices of young Coloradans.

- **Emily Johnson**, Director of Policy Analysis, CHI
- **Suman Mathur**, Program Manager, CHI
- **Alli Daley**, Policy Director, Partners for Children's Mental Health
- Youth leaders from the **Colorado Youth Congress, Young Aspiring Americans for Social and Political Activism, and Youth Council on Mental Health**

CONFERENCE ROOM B

You're Already Making a Difference: How to Amplify Your Role in Climate Adaptation to Advance Health Equity

The task of adapting to a warming climate might seem daunting, but you're already on the path to making a positive difference in your community, even if you're unaware of it. Join us for an illuminating exploration of the synergy between your work and climate change adaptation, through a dynamic "fishbowl" exercise. Discover how to amplify your efforts and explore the inspiring journeys of a health system and a community health organization that have successfully harnessed this connection to support and prepare the communities they serve.

- **Karam Ahmad**, Director, CHI
- **Emily Santich**, Policy Analyst, CHI
- **Lisa Romero**, Senior Community Health Specialist, Kaiser Permanente Colorado
- **Guadalupe Solís**, Director of Environmental Justice, Cultivando

2:15 p.m. – 2:30 p.m. Break Sponsored by Colorado Access

2:30 – 3 p.m. Health Policy and Politics in 2024

The upcoming legislative session will be upon us soon. Here, we will preview the legislative session, which pairs a "back-to-normal" budget with ambitious policy plans. We will also look ahead to the 2024 election, which is already challenging assumptions about what's possible in American politics.

- **Joe Hanel**, Director of Communications, CHI
- **Kendra Neumann**, Research Analyst, CHI

3 – 3:45 p.m. Hearing from Our Legislators

Where exactly is Colorado headed with all the health and social reforms in recent years? Join us as we hear from some of the legislature's leading voices and gain insights in this panel discussion.

- **Rep. Chris deGruy Kennedy**
- **Sen. Rhonda Fields**
- **Sen. Jim Smallwood**
- **Rep. Judy Amabile**
- **Sara Schmitt**, President and CEO, CHI (moderator)

3:45 – 4 p.m. Closing Remarks and Gift Card Drawing

- **Sara Schmitt**, President and CEO, CHI

4 – 5:30 p.m. Reception Sponsored by Colorado Hospital Association, Partners for Children's Mental Health, and the Trailhead Institute



Nita Farahany

*Legal Scholar and Ethicist,
Director of the Duke Initiative
for Science and Society*

Nita Farahany is a leading scholar on the ethical, legal, and social implications of emerging technologies. She is the Robinson O. Everett Distinguished Professor of Law and Philosophy at Duke Law School and the Founding Director of Duke Science & Society. She focuses on the implications of emerging neuroscience, genomics, and artificial intelligence for law and society; legal and bioethical issues arising from the COVID-19 pandemic; FDA law and policy; and the use of science and technology in criminal law. Farahany is the author of *The Battle for Your Brain: Defending Your Right to Think Freely in the Age of Neurotechnology*. Farahany earned an undergraduate degree in Genetics, Cell, and Developmental Biology from Dartmouth College, an MA in biology from Harvard University, and a JD and MA from Duke University, as well as a Ph.D. in philosophy.



Alli Daley

*Policy Director, Partners
for Children's Mental Health*

Alli Daley serves as the Policy Director at Partners for Children's Mental Health and the Senior Behavioral Health Policy Coordinator on the Government Affairs team at Children's Hospital Colorado. Prior to her time at Children's Colorado, Daley litigated mental health and substance use disorder commitments as an Assistant City Attorney with the City and County of Denver. Before that, she lobbied on behalf of Colorado counties at the state legislature. Daley has a BA from Boston University and a JD from the University of Colorado Boulder.



Stephanie Pugliese

*Director, Colorado Office of eHealth
Innovation (OeHI)*

Stephanie Pugliese leads the strategic planning, partnerships, and funding for OeHI in collaboration with the eHealth Commission. She is passionate about leveraging data and technological capabilities to improve individual and public health. Prior to joining OeHI as the State Health IT Coordinator in 2020, Pugliese served as an Operations Advisor for the Governor's Office, where she led the training and implementation efforts for the state in Agile methodology. Previously, Pugliese was a Public Health Investigator for the City and County of Denver, where she led inspections and compliance for food safety. She holds an MPH from Colorado State University.



Lisa Romero

*Senior Community Health Specialist,
Kaiser Permanente Colorado*

Lisa Romero supports investments in community health initiatives related to access to health care and environmental stewardship at Kaiser Permanente. Romero holds a master's degree in public health focused on climate and environmental impacts to human health, and has clinical training as a physician assistant. As a health care provider, she brings a clinical lens to her work in environmental stewardship.



Kaakpema "KP" Yelapaala

Kaakpema "KP" Yelapaala is a global entrepreneur and public health practitioner with a deep understanding of health systems and 20 years of experience

working across the public and private sectors in the U.S., Sub-Saharan Africa, and the Caribbean. He is a Senior Fellow and Lecturer at the Yale School of Public Health. Yelapaala co-founded InOn Health in 2018. The company improved access to care in the U.S. using digital communication channels and consumer insights to better connect multicultural populations to health care services. He also founded access.mobile International, a global digital health company that developed solutions to improve access to health information and services in African countries. Yelapaala received a BA from Brown University and an MPH from the Yale School of Public Health.



Guadalupe Solís

Director of Environmental Justice, Cultivando

Guadalupe Solís joined Cultivando in April 2023. She brings relevant experience in community health needs assessment planning, public health surveillance, and health policy interpretation and analysis. Solís has guided herself through her strong passion for increasing access to health care, advancing health outcomes, and addressing barriers in the way of the health and well-being of her community. She earned her bachelor's degree in biomedical sciences from the University of Northern Colorado and a master's degree with a dual emphasis in epidemiology and health systems management and policy from the Colorado School of Public Health at the Anschutz Medical Campus.



Judy Amabile

Colorado State Representative, District 49

Rep. Judy Amabile was elected to the state House in 2020. She has sponsored measures to increase mental health resources, improve the criminal justice system, increase gun safety, and make communities more resilient in the face of wildfires fueled by the climate crisis. Her son developed a serious mental illness at age 18. She was inspired to seek public office after experiencing our broken mental health care system firsthand. She serves on the House Public & Behavioral Health & Human Services Committee and is chair of the House Business Affairs & Labor Committee. Her district includes mountain communities from Clear Creek to Larimer counties.



Rhonda Fields

Colorado State Senator, District 28

Sen. Rhonda Fields is chair of the Senate Health and Human Services Committee. She has passed over 30 bills in the Senate on community safety, social equity, access to health care, and defending Colorado's middle-class families in meaningful ways. Most recently, she sponsored legislation on cultural training for mental health providers and behavioral health care for people working in the criminal justice system. Fields was elected to the House in 2010 and to the Senate in 2016. She lives in Aurora.



Chris deGruy Kennedy

Colorado State Representative, District 30

Rep. Chris deGruy Kennedy focuses on health care reform, fiscal reform, climate change, and election systems. He has been a leading voice for some of the most important health reforms of recent years, including hospital transparency, the state reinsurance program, the prescription drug affordability board, and value-based payments in primary care. He was elected to the state House in 2016 and is Speaker Pro Tempore of the House. He lives in Lakewood.



Jim Smallwood

Colorado State Senator, District 2

Sen. Jim Smallwood champions affordable and accessible health care for Coloradans and has fought to reduce insurance premiums while working to ensure that all Coloradans have access to quality health care. He also advocates for transparency and fiscal responsibility in government spending. Smallwood was elected to the Senate in 2016 and is the Senate Minority Caucus Chair. He is an insurance broker and lives in Parker.



Youth Leaders

Colorado Youth Congress (CYC), Young Aspiring Americans for Social and Political Activism (YAASPA), and Youth Council on Mental Health (YCMH)

The YCMH is convened by Partners for Children's Mental Health and is a youth-led, adult-supported effort to positively shape the future of youth mental health in Colorado. This year, YCMH has identified social media use as a priority and focus area. The CYC is a youth-led initiative committed to elevating the voices of Colorado youth through empowerment and civic engagement. YAASPA aims to build the self-efficacy of youth who desire to make change in their communities, pursue social science degrees, and social justice careers.



Karam Ahmad

Director

Karam Ahmad leads CHI's Acclimate Colorado health and climate work and oversees evaluation for multiple client projects. His CHI portfolio covers a variety of health policy issues ranging from integrating systems of care, health policy leadership, oral health, healthy equity, behavioral health, and more. Before joining CHI, he worked as a technical writer for Otter Products, LLC (more commonly known as OtterBox). He also was an analyst for the National Park Service and USDA Center for Epidemiological Animal Health. Ahmad earned an MPH from the Colorado School of Public Health at Colorado State University and a certificate in Climate Change and Health from Yale University.



Nina Bianchi

Director

Nina Bianchi has 20 years of experience leading public-private health partnership growth through community innovation, collaboration, and communication. Prior to joining CHI, Bianchi was a Principal for Medallia, where she helped clients accelerate equitable health systems transformation, and was Chief of People and Culture for the U.S. Food and Drug Administration, a special COVID-19 leadership appointment to support human-centered modernization efforts with the Office of Digital Transformation. Bianchi was a White House Presidential Innovation Fellow with the National Cancer Institute and the IT Modernization Centers of Excellence. She designed and managed public-private consulting projects for equitable artificial intelligence at the intersection of patient experience, employee experience, and digital health service delivery. She earned a BFA in communication design from the College for Creative Studies in Detroit.



Jeff Bontrager

Director of Research & Evaluation

Jeff Bontrager oversees CHI's evaluation portfolio and coordinates research efforts related to health insurance, Coloradans who lack insurance, the health care safety net, and health equity. He also supports CHI's Acclimate Colorado team. He serves as principal investigator on the biennial Colorado Health Access Survey and the annual evaluation of The Denver Foundation's Colorado Health Access Fund. Bontrager was a founding member of CHI's Inclusivity, Diversity, and Equity Alliance, and provides facilitation, leadership, and technical expertise for a variety of advisory groups. He earned an MPH from the University of Colorado.



Ashlie Brown

Director

Ashlie Brown focuses on complex systems change — including health information technology, health care delivery systems, and payment reform — and leads CHI's Integrating Systems of Care initiative. She oversaw the development of Colorado's Regional Health Connector Program within a multi-organizational collaboration. Before moving to Colorado, Brown managed the implementation of the Massachusetts State Innovation Model at the Massachusetts Executive Office of Health and Human Services, an effort that included Medicaid payment reform, behavioral health integration in primary care practices, and electronic clinical-community linkages to support population health. She previously worked in the medical device industry and holds two degrees in mechanical engineering.



Joe Hanel

Director of Communications

With nearly 20 years of experience at Colorado newspapers, Joe Hanel communicates CHI's work to a broad audience, including news reporters, legislators, health advocates, and voters. A member of CHI's legislative team, Hanel performs research and analysis on the intersection of politics and policy and the interaction of federal and state health policy. He developed a financial map that tracks federal funds for Colorado governments and agencies through the American Rescue Plan Act. Hanel earned a master's degree in international affairs from the Johns Hopkins University School of Advanced International Studies.



Emily Johnson

Director of Policy Analysis

Emily Johnson uses financial modeling and other forms of quantitative analysis to study how both local and federal health policy proposals could affect Colorado, its budgets, and its residents. She oversees CHI's behavioral health portfolio and leads data analysis for the Colorado Health Access Survey. During the pandemic, Johnson supported the governor's Innovation Response Team and served as a member of CHI's elite Strike Team, formed to quickly respond to the public health crisis. She holds a master's degree in health services research from the University of Colorado. Her academic work focused on the associations between state regulations and nonprofit hospital community benefit spending and behavior.



Kirsti Klaverkamp

Senior Program Manager

Kirsti Klaverkamp oversees development and execution of programs and projects across multisector stakeholder groups, including public health, human services, and community-based, clinical, government, and business organizations at CHI. Prior to joining CHI, she managed operations, quality improvement activities, and regional work groups for the Accountable Health Communities Model, a demonstration project under the U.S. Center for Medicare & Medicaid Innovation. Klaverkamp earned a master's degree in community health from the University of Colorado Denver.



Suman Mathur

Program Manager

Suman Mathur facilitates health promotion and research initiatives with multiple stakeholders across Colorado. She works on CHI's behavioral health team and facilitates the Metro Denver Partnership for Health's Health Equity Steering Committee. She is an adjunct instructor for the Colorado School of Public Health at Colorado State University and serves on its Institutional Review Board. Prior to joining CHI, Mathur worked for the Health District of Northern Larimer County, evaluating behavioral health programs and coordinating the district's triennial Community Health Assessment. She earned a master's degree in public health from the Johns Hopkins Bloomberg School of Public Health.



Kendra Neumann

Research Analyst

Kendra Neumann convenes and engages stakeholders, conducts community health needs assessments, and provides qualitative and quantitative analysis and support on various CHI projects. She serves on CHI's legislative team and created and updates The Colorado Health Foundation's Local Ballot Measure Tracker. As a research assistant at Denver Health, Neumann recruited participants for an opioid use disorder treatment study and administered surveys to study participants. She also coordinated care for patients who tested positive for Hepatitis C. Neumann earned a BA in human rights from Columbia University, concentrating in Russian language and culture and specializing in public health.



Emily Santich

Policy Analyst

Emily Santich is actively involved in CHI assessment work and has led maternal mental and behavioral health assessments for Centura Health and SCL Health (now Intermountain Healthcare) and community health needs assessments for San Luis Valley Health and for several Colorado communities served by Centura Health hospitals. She is part of a team working with the Colorado Department of Early Childhood on a grant that seeks to address gaps in the early child care and education systems for children ages birth through five. Santich also lends her research expertise to CHI's climate and health portfolio and serves on its Inclusivity, Diversity, and Equity Alliance. She earned an MPH in public health from the Boston University School of Public Health.



Sara Schmitt

President and CEO

Sara Schmitt assumed the role of President and CEO of CHI in June 2023, after more than a decade in progressive leadership roles with the organization, including Managing Director of Research, Evaluation, and Consulting and interim President and CEO. Before joining CHI, Schmitt was a policy analyst at the Colorado Rural Health Center, the state office of rural health, and recruited physicians and other medical professionals for clinics and hospitals in Colorado's rural and underserved regions. She spent several years in managed care and program development at the University of Chicago Medical Center. She earned a master's degree in health administration and policy from the University of Chicago.



Lindsey Whittington

Policy Analyst

Lindsey Whittington is a CHI data wunderkind whose work involves quantitative research and analysis of public health surveillance systems, complex statistical modelling, and creating accessible data visualizations. One of their recent projects involved thinking through how to better capture disaggregated race/ethnicity data across Colorado's data systems. Whittington was also the lead data analyst and writer for the 2021 Colorado Health Access Survey. They have had key roles researching and developing interactive data projects for CHI, including the Delta Dental of Colorado Foundation's Oral Health Data Dashboard. They also provide data support for CHI's Acclimate portfolio. Whittington earned an MPH with a concentration in epidemiology from the Colorado School of Public Health at the University of Colorado Anschutz Medical Campus.



We're strengthening
bodies, minds and
communities in the
fight against unfair and
avoidable differences
in health.

coloradohealth.org



The Colorado Health Foundation™

COMING IN **FEBRUARY**

COLORADO HEALTH ACCESS SURVEY

We hope you enjoy today's sneak peek at the 2023 Colorado Health Access Survey results.

Analysis from the CHAS will be a key component of our work next year, beginning with the February 15, 2024, release of a chartpack featuring the top headlines and geographic and demographic breakdowns revealed in the survey data.

And throughout next year, CHI will present an ongoing look at key findings from the CHAS, featuring more of the data analysis, informative graphics, and relevant storylines Colorado has depended on since 2009.



The Colorado Health Access Survey – the CHAS – is the premier source of information on health coverage, access to health care, and the factors that influence health in Colorado.

ORGANIZATIONS REPRESENTED BY ATTENDEES

Adams County Health Department
AgoHealth LLC
Alzheimer's Association of Colorado
American Heart Association / Voices for Healthy Kids
Amgen
Amigos de Mexico
Aponte & Busam Public Affairs
Arlington Family Offices
Boettcher Foundation
Boulder County Public Health
Broomfield Public Health and Environment
Caring for Colorado
Caring for Denver Foundation
Center For African American Health
Center for Improving Value in Health Care
Chronic Care Collaborative
City and County of Broomfield Public Health & Environment
Colorado Academy of Family Physicians
Colorado Access
Colorado Access Foundation
Colorado Alliance for Health Equity and Practice
Colorado Association of Family Medicine Residencies
Colorado Association of Local Public Health Officials
Colorado Behavioral Healthcare Council
Colorado Center on Law and Policy
Colorado Community Health Alliance
Colorado Community Health Network

Colorado Department of Health Care Policy and Financing
Colorado Department of Human Services-PACE Ombudsman
Colorado Department of Public Health and Environment
Colorado Division of Insurance
Colorado Hospital Association
Colorado House of Representatives
Colorado Nurses Association
Colorado Office of eHealth Innovation
Colorado Rural Health Center
Colorado School of Mines
Colorado School of Public Health
Colorado Springs Health Foundation
Colorado State Senate
CommonSpirit Health
Connect for Health Colorado
Contexture
Craig Hospital
CU Anschutz
Cultivando
Diversus Health
Division of Insurance
Doctors Care
El Paso County Public Health
Essential Project
Frontline Public Affairs

GFM|CenterTable
Good Food Collective/La Plata Food Equity Coalition
Grand County government
Healing Lives through Healing Hearts
Health District of Northern Larimer County
Healthier Colorado
Healthy Air and Water Colorado
HeartSmartKids
Homeward Pikes Peak
Icarus Advising
Inner City Health
Intermountain Health
JSI
Kaiser Permanente
Kids First Health Care
Larimer County
LeadingAge Colorado
Marillac Health
Meapta
Mental Health Colorado
Moody Insurance
Mountain Family Health Centers
Out Boulder County
Partners for Children's Mental Health
Peak Health Allinace
Pfizer
Politicalworks

Practice Innovation Program at CU
Public Health Institute at Denver Health
Quality Health Network
Regis University
Results Count Consulting
Rise Against Suicide
Rocky Mountain Health Foundation
Rocky Mountain Health Plans,
A UnitedHealthcare Company
Rose Community Foundation
Servicios de La Raza
Southeast Colorado Hospital District
State of Colorado
StraightLine Health
Sunrise Community Health
The Colorado Health Foundation
The Colorado Trust
The Early Childhood Partnership of Adams County
The Refuge
The Steadman Group
UCHealth
UnitedHealthcare
University of Colorado Anschutz Medical Campus
University of Colorado School of Public Health
Upstream, USA
Valley-Wide Health Systems
WellPower
Yale School of Public Health
Youth Healthcare Alliance